

SUPER START⁺ LAWN & GARDEN

LAWN & GARDEN BATTERIES



Electrical short prevention system –

Protects power producing components from life-robbing electrical shorts

Vibration resistance design – Reinforced posts, straps, and welds withstand demanding conditions

Maintenance-free, flush cover design – Maximizes convenience, minimizes water loss for extended operation

Optimized Power, full-framed plates –

Better withstands severe service demands while optimizing current transfer

Tough polypropylene case and cover – Resist external damage from tough outdoor use

Side, safety vent system – Prevents acid leaks up to a 45° tilt keeping battery dry and corrosion-free

These maintenance-free Lawn & Garden batteries have all of the cranking amps necessary to power tractors and other small utility vehicles across the roughest terrain. Their easy-to-install, flush cover design fits better for a garden tractor replacement. A tough exterior case and cover is ideal for outdoor use resisting damage, even under the roughest conditions. Side vents eliminate acid leaks up to a 45° tilt and keep the battery top dry and corrosion-free. Built to maximize convenience and extend performance, these Lawn & Garden batteries have the quality and dependable starting power that lasts from season to season.

LAWN & GARDEN SPECIFICATIONS

Group Number	Part Number	Performance Level			Weight (lbs.)	Max. Overall Dimensions (Inch)			Terminal Position	Footnote
		CCA @ 0°F	R.C.	CA @ 32°F		Length	Width	Height		
12-VOLT GARDEN TRACTOR / SMALL ENGINE STARTING — SUPER START LAWN & GARDEN										
U1	U1L	150	—	185	14.5	7-3/4	5-1/8	7-1/4	1	22,Z
	U1LH	230	—	285	15.5	7-3/4	5-1/8	7-1/4	1	22,Z
	U1LUH	350	—	430	19	7-3/4	5-1/8	7-1/4	1	22,Z
U1R	U1RH	230	—	285	15.5	7-3/4	5-1/8	7-1/4	2	22,Y
	U1RUH	350	—	430	19	7-3/4	5-1/8	7-1/4	2	22,Y
22NF	22NF	360	58	445	29	9-3/8	5-1/2	9	2	12, S

FOOTNOTES:

- 12 – Hybrid construction
- 22 – Flush manifold vented cover
- Batteries are maintenance-free calcium grids, except where noted
- Weights are approximates
- CA ratings @ 32°F is an approximation, for comparison only
- CCA and RC ratings conform to B.C.I. specifications

TERMINAL PICTURES

- S. SAE "automotive type" post
- Y. Small L terminal with round hole
- Z. Small L terminal with square hole

TERMINAL POSITIONS

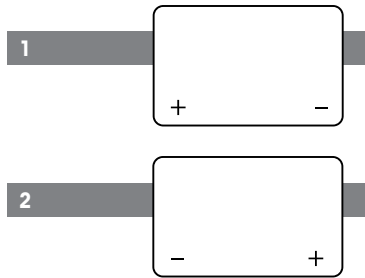

LAWN & GARDEN ACCESSORIES

GARDEN TRACTOR NUT & BOLT

- Zinc-plated
- Fits group U1 batteries
- Includes set of 2 nuts & bolts

SS 01345

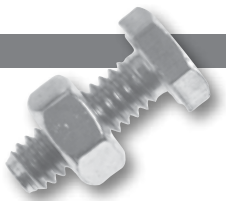

TERMINAL DESIGN Y

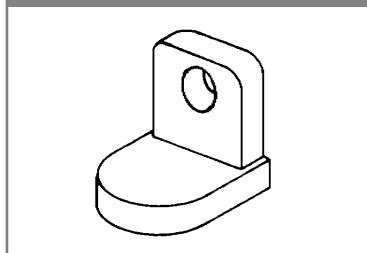

TERMINAL DESIGN Z

